

Figura	Ref ^o ADR98	Aplicación	Descripción	Medidas
1	2606309.0	BPW	TAPACUBO PEQUEÑO 6,5-9 TNS CONV	M115 X 2
2	3006820.1	BPW	PASADOR TUERCA BUJE	Ø 8 X 50 MM
3	3006608.0	BPW	TUERCA BUJE 6,5-9 TNS	M42 X 2 SW65
4	3206250.0	BPW	RODAMIENTO EXTERIOR 6,5-9 TNS	Ø 50 X 110 X 42 MM
4A	3206050.1	BPW	RODAMIENTO EXTERIOR 6,5-9 TNS	32310
5	3206240.0	BPW	RODAMIENTO INTERIOR 6,5-9 TNS	Ø 80 X 130 X 37 MM
5A	3206080.1	BPW	RODAMIENTO INTERIOR 6,5-9 TNS	33116
6	3206415.0	BPW	CHAPA PROTECTOR RODAMIENTO	Ø 84 X 129 X 8,5
7	2806732.0	BPW	ARANDELA RETEN FIBRA 6,5-9 TNS	Ø 104 X 136 X 2,5 MM
8	2806731.0	BPW	ARANDELA RETEN FIBRA 6,5-9 TNS	Ø 110 X 141 X 2,5 MM
9	2806648.0	BPW	ANILLO PORTA-RETEN 6,5-9 TNS	Ø 85 X 112/142 X 20 MM
10	2206041.0	BPW	BUJE RUEDA HS/HZ 6,5-9 TNS	10T. X 22 MM
11	2406317.0	BPW	PERNO RUEDA DOBLE	L = 115 MM M22*150-M22*200
11A	2406115.0	BPW	PERNO RUEDA DOBLE	L = 115 MM M22*150-M22*200
12	2406315.0	BPW	PERNO RUEDA SENCILLA	L = 100 MM M22*150/M22*200
12A	2406100.0	BPW	PERNO RUEDA SENCILLA	L = 100 MM M22*150/M22*200
13	2522200.5	BPW	TUERCA INTERIOR PERNO	M22*200 SW32
14	2522150.1	BPW	TUERCA VOLANDERA PARA PERNO	M22*150 SW32 ALT. 30MM
15	1906815.0	BPW	CORONA ABS 100 DIENTES	Ø 152 X 170 X 15 MM
16	1906050.0	BPW	SENSOR ABS 0,4 MM	
17	1906709.0	BPW	SOPORTE SENSOR DERECHO	
17A	1906710.0	BPW	SOPORTE SENSOR IZQUIERDO	



Figura	Ref ^o ADR98	Aplicación	Descripción	Medidas
1	2606407.0	BPW	TAPACUBO GRANDE 10-12 TNS CONV	M125 X 2
2	3006840.1	BPW	PASADOR TUERCA BUJE	Ø 8 X 63 MM
3	3006718.0	BPW	TUERCA BUJE 10-12 TNS CONV	M52 X 2 SW 80
4	3206220.0	BPW	RODAMIENTO EXTERIOR 10-12 TNS	Ø 65 X 120 X 42 MM
4A	3206065.1	BPW	RODAMIENTO EXTERIOR 10-12 TNS	33213
5	3206230.0	BPW	RODAMIENTO INTERIOR 10-12 TNS	Ø 90 X 150 X 47 MM
5A	3206090.1	BPW	RODAMIENTO INTERIOR 10-12 TNS	33118
6	3206522.0	BPW	CHAPA PROTECTOR RODAMIENTO	Ø 94 X 149 X 8,5 MM
7	2806730.0	BPW	ARANDELA RETEN FIBRA 10-12 TNS	Ø 120 X 158 X 2,5 MM
8	2806821.0	BPW	ARANDELA RETEN FIBRA 10-12 TNS	Ø 128 X 165 X 2,5 MM
9	2806743.0	BPW	ANILLO PORTA-RETEN 10-12 TNS	Ø 95 X 120/165 X 20 MM
10	2206846.0	BPW	BUJE RUEDA HS/HZ 10-12 TNS CONV	10T.X 22 MM
11	2406317.0	BPW	PERNO RUEDA DOBLE	L= 115 MM M22*150-M22*200
11A	2406115.0	BPW	PERNO RUEDA DOBLE	L= 115 MM M22*150-M22*200
12	2406315.0	BPW	PERNO RUEDA SENCILLA	L= 100 MM M22*150/M22*200
12A	2406100.0	BPW	PERNO RUEDA SENCILLA	L= 100 MM M22*150/M22*200
13	2522200.5	BPW	TUERCA INTERIOR PERNO	M22*200 SW32
14	2522150.1	BPW	TUERCA VOLANDERA PARA PERNO	M22*150 SW32 ALT. 30MM
15	1906814.0	BPW	CORONA ABS 100 DIENTES	Ø 176 X 194 X 15 MM
16	1906050.0	BPW	SENSOR ABS 0,4 MM	
17	1906758.0	BPW	SOPORTE SENSOR DERECHO	
17A	1906759.0	BPW	SOPORTE SENSOR IZQUIERDO	



Figura	Refº ADR98	Aplicación	Descripción	Medidas
1	2606425.0	BPW	TAPACUBO PEQUEÑO ECO 6,5-9 TNS	M115 X 2
2	3006306.0	BPW	CLIPS TUERCA BUJE 6,5 - 9 TNS ECO	54 X 2
3	3006117.0	BPW	PASADOR FIJACION GRUPILLA	Ø 8 X 45 MM
4	3006602.0	BPW	TUERCA BUJE ECO 6,5-9 TNS	M42 X 2 SW 65
5	3206250.0	BPW	RODAMIENTO EXTERIOR 6,5-9 TNS	Ø 50 X 110 X 42 MM
5A	3206050.1	BPW	RODAMIENTO EXTERIOR 6,5-9 TNS	32310
6	3206240.0	BPW	RODAMIENTO INTERIOR 6,5-9 TNS	Ø 80 X 130 X 37 MM
6A	3206080.1	BPW	RODAMIENTO INTERIOR 6,5-9 TNS	33116
7	3006129.0	BPW	CIR-CLIPS DE SEGURIDAD EXTERIOR	Ø 112 X 4 DIN 472
8	3206516.0	BPW	ANILLO EMPUJE ECO 6,5-9 TNS.	Ø 53 X 98 X 8 MM
9	3006313.0	BPW	ARANDELA TOPE ECO 6,5-9 TNS	Ø 43 X 61 X 5,8 MM
10	3206333.0	BPW	CHAPA PROTECTOR RODAMIENTO ECO 6-9	Ø 84 X 129 X 8,5 MM
11	2806760.0	BPW	ANILLO PORTA-RETEN ECO 6,5-9 TNS	Ø 86 / 115 X 139 X 22 MM
12	2806620.0	BPW	CHAPA PROTECTOR RETEN 6,5-9 TNS	Ø 131 X Ø 140 X 12 MM
13	2806570.0	BPW	RETEN BUJE ECO 6,5-9 TNS	Ø 115 X Ø 137 X 10,5 MM
13A	2806020.1	BPW	RETEN BUJE ECO 6,5-9 TNS	Ø 115 X Ø 137 X 10,5 MM
14	3006409.0	BPW	CIR-CLIPS DE SEGURIDAD INTERIOR	Ø 140 X 4 DIN 472
15	1906815.0	BPW	CORONA ABS 100 DIENTES	Ø 152 X 170 X 15 MM
16	2206087.0	BPW	BUJE RUEDA HS/HZ ECO 6,5-9 TNS	10T X 22 MM
17	1906758.0	BPW	SOPORTE SENSOR DERECHO	
17A	1906759.0	BPW	SOPORTE SENSOR IZQUIERDO	
18	1906050.0	BPW	SENSOR ABS 0,4 MM	
19	2406315.0	BPW	PERNO RUEDA SENCILLA	L = 100 MM M22*150/M22*200
19A	2406100.0	BPW	PERNO RUEDA SENCILLA	L = 100 MM M22*150/M22*200
20	2522200.5	BPW	TUERCA INTERIOR PERNO	M22*200 SW32
21	2406317.0	BPW	PERNO RUEDA DOBLE	L = 115 MM M22*150-M22*200
21A	2406115.0	BPW	PERNO RUEDA DOBLE	L = 115 MM M22*150-M22*200
22	2522150.1	BPW	TUERCA VOLANDERA PARA PERNO	M22*150 SW32 ALT. 30MM



Figura	Refª ADR98	Aplicación	Descripción	Medidas
1	2606508.0	BPW	TAPACUBO GRANDE ECO 10-12 TNS	M135 X 2
2	3006408.0	BPW	CLIPS TUERCA BUJE 10-12 TNS	66 X 2
3	3006117.0	BPW	PASADOR FIJACION GRUPILLA	Ø 8 X 45 MM
4	3006703.0	BPW	TUERCA BUJE ECO 10-12 TNS	M52 X 2 SW 80
5	3206220.0	BPW	RODAMIENTO EXTERIOR 10-12 TNS	Ø 65 X 120 X 42 MM
5A	3206065.1	BPW	RODAMIENTO EXTERIOR 10-12 TNS	33213
6	3206230.0	BPW	RODAMIENTO INTERIOR 10-12 TNS	Ø 90 X 150 X 47 MM
6A	3206090.1	BPW	RODAMIENTO INTERIOR 10-12 TNS	33118
7	3006229.0	BPW	CIR-CLIPS DE SEGURIDAD EXTERIOR	Ø 122 X 4 DIN 472
8	3206624.0	BPW	ANILLO EMPUJE ECO 10-12 TNS.	Ø 71 X 108 X 9,5 MM
9	3006401.0	BPW	ARANDELA ECO 10-12 TNS	Ø 53 X 76 X 5,8 MM
10	3206334.0	BPW	CHAPA PROTECTOR RODAMIENTO ECO 10-12	Ø 94 X 149 X 8,5 MM
11	2806762.0	BPW	ANILLO PORTA-RETEN ECO 10-12 TNS	Ø 96 / 135 X 159 X 22
12	2806630.0	BPW	CHAPA PROTECTOR RETEN 10-12 TNS	Ø 151 / 160 X 12 MM
13	2806580.0	BPW	RETEN BUJE ECO 10-12 TNS	Ø 135 X 157 X 8 MM
14	2806609.0	BPW	CIR-CLIPS DE SEGURIDAD INTERIOR	Ø 160 X 4 DIN 472
15	1906814.0	BPW	CORONA ABS 100 DIENTES	Ø 176 X 194 X 15 MM
16	2206320.0	BPW	BUJE RUEDA HS/HZ ECO 10-12 TNS	10T X 22 MM
17	1906758.0	BPW	SOPORTE SENSOR DERECHO	
17A	1906759.0	BPW	SOPORTE SENSOR IZQUIERDO	
18	1906050.0	BPW	SENSOR ABS 0,4 MM	
19	2406315.0	BPW	PERNO RUEDA SENCILLA	L = 100 MM M22*150/M22*200
19A	2406100.0	BPW	PERNO RUEDA SENCILLA	L = 100 MM M22*150/M22*200
20	2522200.5	BPW	TUERCA INTERIOR PERNO	M22*200 SW32
11	2406317.0	BPW	PERNO RUEDA DOBLE	L = 115 MM M22*150-M22*200
11A	2406115.0	BPW	PERNO RUEDA DOBLE	L = 115 MM M22*150-M22*200
22	2522150.1	BPW	TUERCA VOLANDERA PARA PERNO	M22*150 SW32 ALT. 30MM

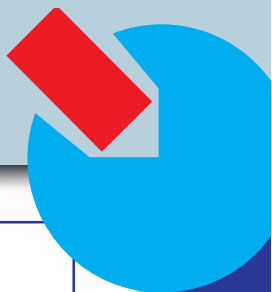

Figura	Refº ADR98	Aplicación	Descripción	Medidas
1	2606533.0	BPW	TAPACUBO PEQUEÑO ECO MAX 9 TNS	M136 X 2,5
2	3006306.0	BPW	CLIPS TUERCA BUJE 6,5 - 9 TNS ECO	54 X 2
3	3006117.0	BPW	PASADOR FIJACION GRUPILLA	Ø 8 X 45 MM
4	3006602.0	BPW	TUERCA BUJE ECO 6,5-9 TNS	M42 X 2 SW 65
5	3206250.0	BPW	RODAMIENTO EXTERIOR 6,5-9 TNS	Ø 50 X 110 X 42 MM
5A	3206050.1	BPW	RODAMIENTO EXTERIOR 6,5-9 TNS	32310
6	3206240.0	BPW	RODAMIENTO INTERIOR 6,5-9 TNS	Ø 80 X 130 X 37 MM
6A	3206080.1	BPW	RODAMIENTO INTERIOR 6,5-9 TNS	33116
7	3006129.0	BPW	CIR-CLIPS DE SEGURIDAD EXTERIOR	Ø 112 X 4 DIN 472
8	3206516.0	BPW	ANILLO EMPUJE ECO 6,5-9 TNS.	Ø 53 X 98 X 8 MM
9	3006313.0	BPW	ARANDELA TOPE ECO 6,5-9 TNS	Ø 43 X 61 X 5,8 MM
10	3206333.0	BPW	CHAPA PROTECTOR RODAMIENTO ECO 6-9	Ø 84 X 129 X 8,5 MM
11	2806760.0	BPW	ANILLO PORTA-RETEN ECO 6,5-9 TNS	Ø 86 / 115 X 139 X 22 MM
12	2806620.0	BPW	CHAPA PROTECTOR RETEN 6,5-9 TNS	Ø 131 X Ø 140 X 12 MM
13	2806570.0	BPW	RETEN BUJE ECO 6,5-9 TNS	Ø 115 X Ø 137 X 10,5 MM
13A	2806020.1	BPW	RETEN BUJE ECO 6,5-9 TNS	Ø 115 X Ø 137 X 10,5 MM
14	3006409.0	BPW	CIR-CLIPS DE SEGURIDAD INTERIOR	Ø 140 X 4 DIN 472
15	1906815.0	BPW	CORONA ABS 100 DIENTES	Ø 152 X 170 X 15 MM
16	2206097.0	BPW	BUJE RUEDA HS/HZ ECO MAX 6,5-9 TNS	10T X 22 MM
17	1906758.0	BPW	SOPORTE SENSOR DERECHO	
17A	1906759.0	BPW	SOPORTE SENSOR IZQUIERDO	
18	1906050.0	BPW	SENSOR ABS 0,4 MM	
19	2406311.1	BPW	PERNO RUEDA AXIAL R/S FRENO DISCO	L = 80 M22*150
20	2406314.1	BPW	PERNO RUEDA AXIAL UNIFICADO	L = 89 M22*150
21	2406312.1	BPW	PERNO RUEDA AXIAL RS/ALU - RD/ACERO	L = 97 M22*150
22	2400022.2	BPW	CENTRADOR PERNO LLANTA	Ø 22 X 23 MM
23	2522150.1	BPW	TUERCA VOLANDERA PARA PERNO	M22*150 SW32 ALT. 30MM



Figura	Ref ^a ADR98	Aplicación	Descripción	Medidas
1	2606533.0	BPW	TAPACUBO GRANDE ECO MAX 10-12 TNS	M136 X 2,5
2	3006408.0	BPW	CLIPS TUERCA BUJE 10-12 TNS	66 X 2
3	3006117.0	BPW	PASADOR FIJACION GRUPILLA	Ø 8 X 45 MM
4	3006703.0	BPW	TUERCA BUJE ECO 10-12 TNS	M52 X 2 SW 80
5	3206220.0	BPW	RODAMIENTO EXTERIOR 10-12 TNS	Ø 65 X 120 X 42 MM
5A	3206065.1	BPW	RODAMIENTO EXTERIOR 10-12 TNS	33213
6	3206230.0	BPW	RODAMIENTO INTERIOR 10-12 TNS	Ø 90 X 150 X 47 MM
6A	3206090.1	BPW	RODAMIENTO INTERIOR 10-12 TNS	33118
7	3006229.0	BPW	CIR-CLIPS DE SEGURIDAD EXTERIOR	Ø 122 X 4 DIN 472
8	3206624.0	BPW	ANILLO EMPUJE ECO 10-12 TNS.	Ø 71 X 108 X 9,5 MM
9	3006401.0	BPW	ARANDELA ECO 10-12 TNS	Ø 53 X 76 X 5,8 MM
10	3206334.0	BPW	CHAPA PROTECTOR RODAMIENTO ECO 10-12	Ø 94 X 149 X 8,5 MM
11	2806762.0	BPW	ANILLO PORTA-RETEN ECO 10-12 TNS	Ø 96 / 135 X 159 X 22
12	2806630.0	BPW	CHAPA PROTECTOR RETEN 10-12 TNS	Ø 151 / 160 X 12 MM
13	2806580.0	BPW	RETEN BUJE ECO 10-12 TNS	Ø 135 X 157 X 8 MM
14	2806609.0	BPW	CIR-CLIPS DE SEGURIDAD INTERIOR	Ø 160 X 4 DIN 472
15	1906814.0	BPW	CORONA ABS 100 DIENTES	Ø 176 X 194 X 15 MM
16	2206312.0	BPW	BUJE RUEDA HS/HZ ECO MAXX 10-12 TNS	10T X 22 MM
17	1906758.0	BPW	SOPORTE SENSOR DERECHO	
17A	1906759.0	BPW	SOPORTE SENSOR IZQUIERDO	
18	1906050.0	BPW	SENSOR ABS 0,4 MM	
19	2406311.1	BPW	PERNO RUEDA AXIAL R/S FRENO DISCO	L = 80 M22*150
20	2406314.1	BPW	PERNO RUEDA AXIAL UNIFICADO	L = 89 M22*150
21	2406312.1	BPW	PERNO RUEDA AXIAL RS/ALU - RD/ACERO	L = 97 M22*150
22	2400022.2	BPW	CENTRADOR PERNO LLANTA	Ø 22 X 23 MM
23	2522150.1	BPW	TUERCA VOLANDERA PARA PERNO	M22*150 SW32 ALT. 30MM

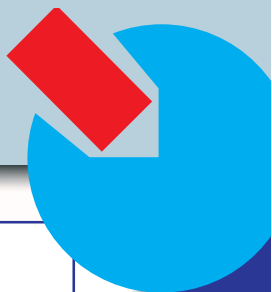

Figura	Refº ADR98	Aplicación	Descripción	Medidas
1	2606531.0	BPW	TAPACUBOS BUJE ECO-PLUS	M136 X 2,5 SW 110
2	3006410.0	BPW	CIR-CLIP TUERCA BUJE ECO-PLUS	
3	3006007.0	BPW	CUÑA SEGURIDAD TUERCA BUJE ECO-PLUS	
4	3006706.0	BPW	TUERCA BUJE ECO-PLUS CON PAR DE APRIETE	M52 X 2 SW95
5	3206220.0	BPW	RODAMIENTO EXTERIOR	Ø 65 X 120 X 42 MM
5A	3206065.1	BPW	RODAMIENTO EXTERIOR	33213
6	3206230.0	BPW	RODAMIENTO INTERIOR	Ø 90 X 150 X 47 MM
6A	3206090.1	BPW	RODAMIENTO INTERIOR	33118
7	3006229.0	BPW	CIR-CLIP SEGURIDAD EXTERIOR	Ø 122 X 4 DIN 472
8	3206624.0	BPW	ANILLO EMPUJE ECO-PLUS	Ø 71 X Ø 108 X 8 MM
9	3006401.0	BPW	ARANDELA TOPE ECO-PLUS	Ø 53 X 76 X 5,8 MM
10	3206334.0	BPW	CHAPA PROTECTOR RODAMIENTO	Ø 94 X 149 X 8,5 MM
11	2806680.0	BPW	RETEN (< 10 / 2004)	Ø 120 X Ø 157,5 X 20 MM
11A	2806740.0	BPW	CONJUNTO RETEN COMPLETO (> 10/2004)	Ø 117,5 X Ø 158 X 17,5 MM
12	3206515.0	BPW	GUARDAPOLVOS PLASTICO	Ø 67 X Ø 95 X 49,5 MM
13	2806800.0	BPW	CHAPA PROTECTORA DE RETEN (< 10 / 2004)	Ø 151 X Ø 157,6 X 20 MM
14	2806589.0	BPW	CIR-CLIP SEGURIDAD INTERIOR	Ø 158 X 4 DIN 472
15	1906851.0	BPW	CORONA ABS CHAPA 100 DIENTES	Ø 150 X Ø 180 X 19,5 MM
16	2206310.0	BPW	BUJE RUEDA ECO-PLUS 6,5 - 9 TNS.	10T X 22 MM
17	1906461.0	BPW	SOPORTE SENSOR ECO-PLUS RECTO	
18	1906050.0	BPW	SENSOR ABS 0,4 MM	
19	2406311.1	BPW	PERNO RUEDA AXIAL R/S FRENO DISCO	L = 80 M22*150
20	2406314.1	BPW	PERNO RUEDA AXIAL UNIFICADO	L = 89 M22*150
21	2406312.1	BPW	PERNO RUEDA AXIAL RS/ALU - RD/ACERO	L = 97 M22*150
22	2400022.2	BPW	CENTRADOR PERNO LLANTA	Ø 22 X 23 MM
23	2522150.1	BPW	TUERCA VOLANDERA PARA PERNO	M22*150 SW32 ALT. 30MM



Figura	Refª ADR98	Aplicación	Descripción	Medidas
1	2606531.0	BPW	TAPACUBOS BUJE ECO-PLUS	M136 X 2,5 SW 110
2	3006410.0	BPW	CIR-CLIP TUERCA BUJE ECO-PLUS	
3	3006007.0	BPW	CUÑA SEGURIDAD TUERCA BUJE ECO-PLUS	
4	3006706.0	BPW	TUERCA BUJE ECO-PLUS CON PAR DE APRIETE	M52 X 2 SW95
5	3206220.0	BPW	RODAMIENTO EXTERIOR	Ø 65 X 120 X 42 MM
5A	3206065.1	BPW	RODAMIENTO EXTERIOR	33213
6	3206230.0	BPW	RODAMIENTO INTERIOR	Ø 90 X 150 X 47 MM
6A	3206090.1	BPW	RODAMIENTO INTERIOR	33118
7	3006229.0	BPW	CIR-CLIP SEGURIDAD EXTERIOR	Ø 122 X 4 DIN 472
8	3206624.0	BPW	ANILLO EMPUJE ECO-PLUS	Ø 71 X Ø 108 X 8 MM
9	3006401.0	BPW	ARANDELA TOPE ECO PLUS	Ø 53 X 76 X 5,8 MM
10	3206334.0	BPW	CHAPA PROTECTOR RODAMIENTO	Ø 94 X 149 X 8,5 MM
11A	2806580.0	BPW	RETEN (== > 01 / 2005)	Ø 135 X Ø 157 X 8 MM
11	2806740.0	BPW	CONJUNTO RETEN COMPLETO (01 / 2005 == >)	Ø 117,5 X Ø 158 X 17,5 MM
12	3206515.0	BPW	GUARDAPOLVOS PLASTICO	Ø 67 X Ø 93 X 90,5 MM
13	2806630.0	BPW	CHAPA PROTECTORA DE RETEN (== > 01 / 2005)	Ø 151 X Ø 160 X 12 MM
14	2806409.0	BPW	CIR-CLIP SEGURIDAD INTERIOR (== > 01 / 2005)	Ø 140 X 4 DIN 472
14A	2806589.0	BPW	CIR-CLIP SEGURIDAD INTERIOR (01 / 2005 == >)	Ø 158 X 4 DIN 472
15	1906854.0	BPW	CORONA ABS CHAPA 120 DIENTES	Ø 150 X Ø 180 X 19,5 MM
16	2206312.0	BPW	BUJE RUEDA ECO-PLUS 10-12 TNS.	10T X 22 MM
17	1906461.0	BPW	SOPORTE SENSOR ECO-PLUS RECTO	
18	1906050.0	BPW	SENSOR ABS 0,4 MM	
19	2406311.1	BPW	PERNO RUEDA AXIAL R/S FRENO DISCO	L = 80 M22*150
20	2406314.1	BPW	PERNO RUEDA AXIAL UNIFICADO	L = 89 M22*150
21	2406312.1	BPW	PERNO RUEDA AXIAL RS/ALU - RD/ACERO	L = 97 M22*150
22	2400022.2	BPW	CENTRADOR PERNO LLANTA	Ø 22 X 23 MM
23	2522150.1	BPW	TUERCA VOLANDERA PARA PERNO	M22*150 SW32 ALT. 30MM

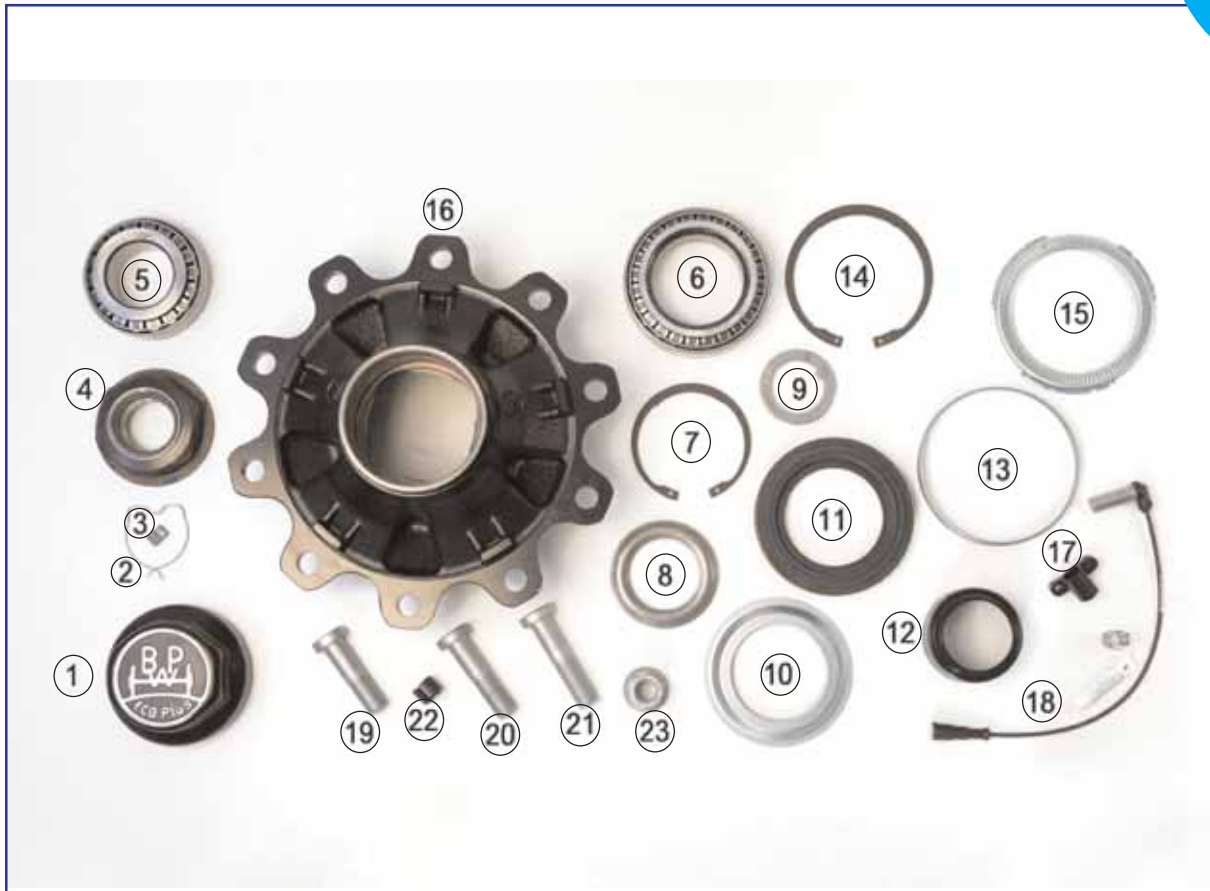

1

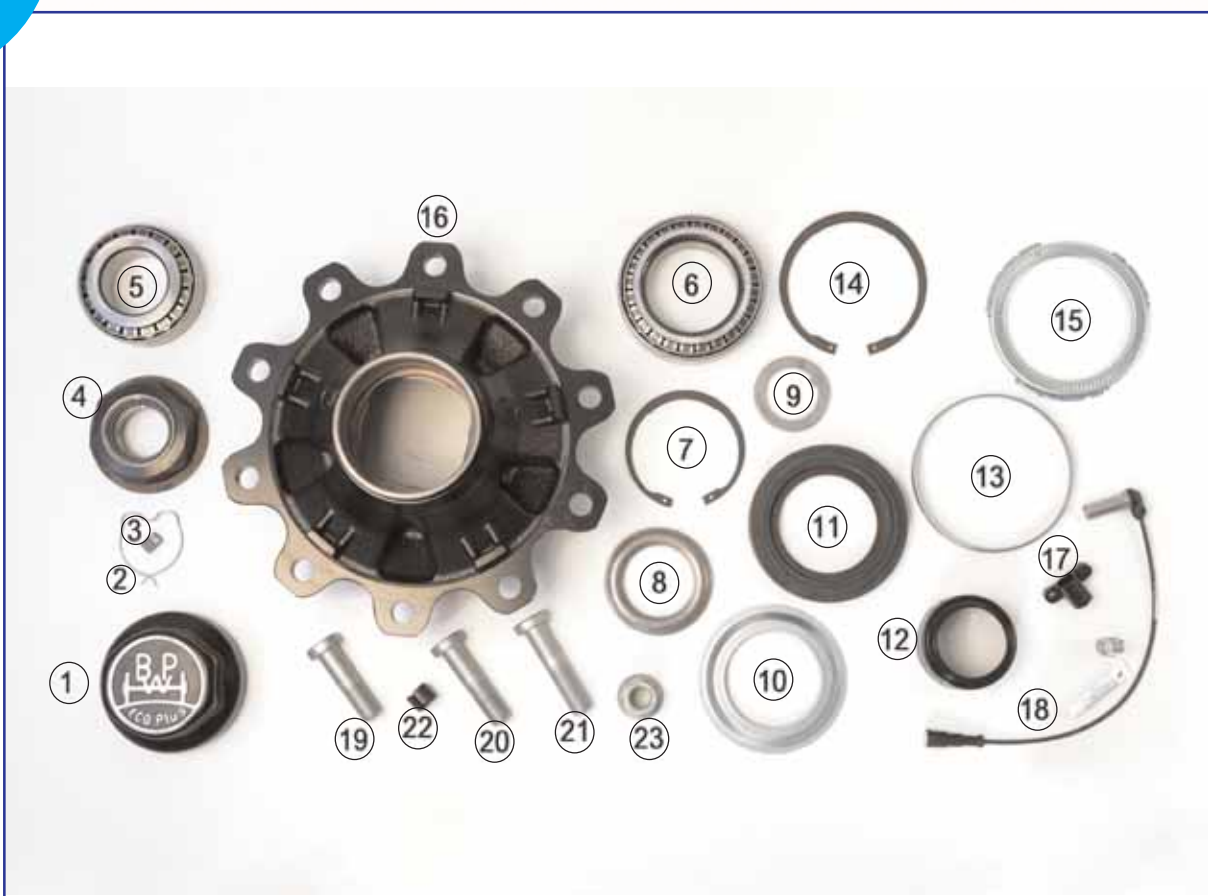
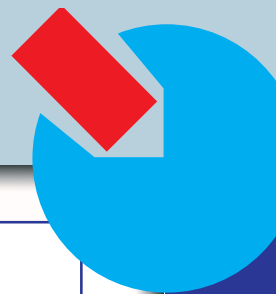

2

Figura	Refº ADR98	Aplicación	Descripción	Medidas
1	3206311.7	BPW	KIT REP. RODAMIENTOS COMPLETO CONV. 6-9T.	
1A	3206311.8	BPW	KIT REP. RODAMIENTOS COMPLETO CONV. 10-12T	
1B	3206313.3	BPW	KIT REP. RODAMIENTOS COMPLETO ECO 6-9 T.	
1C	3206313.4	BPW	KIT REP. RODAMIENTOS COMPLETO ECO 10-12T.	
1D	3206312.6	BPW	KIT REP. RODAMIENTOS COMPLETO ECO-PLUS 6T.	
1E	3206312.7	BPW	KIT REP. RODAMIENTOS COMPLETO ECO-PLUS 10T.	
2	2206360.3	BPW	CJTO. BUJE ECO 6,5 - 9 TNS. COMPLETO	
2A	2206360.4	BPW	CJTO. BUJE ECO 10-12 TNS. COMPLETO	
2B	2206360.5	BPW	CJTO. BUJE ECO MAX 6,5 - 9 TNS. COMPLETO	
2C	2206360.6	BPW	CJTO. BUJE ECO MAX 10 - 12 TNS. COMPLETO	
2D	2206360.7	BPW	CJTO. BUJE ECO-PLUS 6,5 - 9 TNS. COMPLETO	
2E	2206360.8	BPW	CJTO. BUJE ECO-PLUS 10 - 12 TNS. COMPLETO	



Figura	Ref ^a ADR98	Aplicación	Descripción	Medidas
*	2006150.6	BPW	TAMBOR FRENO 300 X 200 NHZ ECO-MAX	190 - 225 - 260 - 10T. X Ø 23 MM
*	2006154.0	BPW	TAMBOR FRENO 300 X 200 NR - S / Z	190 - 225 - 295 - 10T. X Ø 23 MM
*	2006154.9	BPW	TAMBOR FRENO 300 X 200 NR - S / Z	190 - 225 - 265 - 10T. X Ø 23 MM
*	2006190.3	BPW	TAMBOR FRENO 360 X 200 K ECOMAX - ECO PLUS	230 - 275 - 260 - 8T. X Ø 23 MM
*	2006190.4	BPW	TAMBOR FRENO 360 X 200 K ECOMAX - ECO PLUS	190 - 225 - 260 - 10T. X Ø 23 MM
*	2006192.2	BPW	TAMBOR FRENO 360 X 200 KH / KR - S	230 - 275 - 263 - 8T. X Ø 23 MM
*	2006192.4	BPW	TAMBOR FRENO 360 X 200 KH / KR / KM	190 - 225 - 263 - 10T. X Ø 23 MM
*	2006201.3	BPW	TAMBOR FRENO 420 X 180 HS	290 - 335 - 226 - 10T. X Ø 23 MM
*	2006201.9	BPW	TAMBOR FRENO 420 X 180 HS ECOMAX - ECO PLUS	290 - 335 - 226 - 10T. X Ø 23 MM
*	2006202.1	BPW	TAMBOR FRENO 420 X 180 HZ ECOMAX - ECO PLUS	290 - 335 - 249 - 10T. X Ø 23 MM
*	2006207.4	BPW	TAMBOR FRENO 420 X 180 HS / HZ	290 - 335 - 252 - 10T. X Ø 23 MM
*	2006201.6	BPW	TAMBOR FRENO 420 X 200 HS	290 - 335 - 260 - 10T. X Ø 23 MM
*	2006201.7	BPW	TAMBOR FRENO 420 X 200 HS ECOMAX - ECO PLUS	290 - 335 - 259 - 10T. X Ø 23 MM
*	2006201.8	BPW	TAMBOR FRENO 420 X 200 HZ ECOMAX - ECO PLUS	290 - 335 - 287 - 10T. X Ø 23 MM
*	2006207.2	BPW	TAMBOR FRENO 420 X 200 HS / HZ	290 - 335 - 287 - 10T. X Ø 23 MM



Figura	Refº ADR98	Aplicación	Descripción	Medidas
*	4806150.3	BPW	CJTO. GUARDAPOLVOS SN3020-1 Ø 127	
*	4806190.6	BPW	CJTO. GUARDAPOLVOS SN3620 KH - 120	
*	4806198.1	BPW	CJTO. GUARDAPOLVOS SN3620 KR Ø 127	
*	4806198.3	BPW	CJTO. GUARDAPOLVOS SN3620 KH - 150	
*	4806207.1	BPW	CJTO. GUARDAPOLVOS SN4218 30º == > 1995	
*	4806207.2	BPW	CJTO. GUARDAPOLVOS SN4218 Ø 127	
*	4806207.3	BPW	CJTO. GUARDAPOLVOS SN4220 - 150	
*	4806207.5	BPW	CJTO. GUARDAPOLVOS SN4220 30º - 120	
*	4806207.9	BPW	CJTO. GUARDAPOLVOS SN4220 HLL - 120	
*	4806208.0	BPW	CJTO. GUARDAPOLVOS SN4218 - 150	
*	4806208.8	BPW	CJTO. GUARDAPOLVOS SN4218-2 16º - 120	
*	4806208.9	BPW	CJTO. GUARDAPOLVOS SN4220-2 16º - 120	
*	4806209.3	BPW	CJTO. GUARDAPOLVOS SN4218 - 120	
*	4806209.5	BPW	CJTO. GUARDAPOLVOS SN4218 - 150	
*	4806209.7	BPW	CJTO. GUARDAPOLVOS SN4220 16º - 120	
*	4806209.8	BPW	CJTO. GUARDAPOLVOS SN4218/4220 25º - 150	
*	4806209.9	BPW	CJTO. GUARDAPOLVOS SN4220 HLL A/DIREC.	



Figura	Refª ADR98	Aplicación	Descripción	Medidas
1	3506480.0	BPW	MORDAZA DE FRENO SN 3020 ECO	300 X 200 MM
2	3506907.0	BPW	MORDAZA DE FRENO SN 3620	360 X 200 MM
2A	3506934.0	BPW	MORDAZA DE FRENO SN 3620 ECO	360 X 200 MM
3	4406406.0	BPW	MUELLE TENSOR ZAPATA	105 X 21 X 4 MM
4	4406416.0	BPW	MUELLE RECUPERACION ZAPATA 15"	166 X 20 X 3,6 MM
4A	4406613.0	BPW	MUELLE RECUPERACION ZAPATA 19,5"	236 X 24,5 X 4 MM
5	4106312.6	BPW	KIT RODILLO ZAPATA	Ø 26 MM
6	4106310.1	BPW	KIT RODILLO ZAPATA ECO COMPLETO	Ø 58 X 31 MM
7	4006202.0	BPW	CIR-CLIPS BULON PLATO ANCLAJE ECO T.MOD.	Ø 32 X 10 X 2 MM
8	4406306.0	BPW	MUELLE POSICIONAMIENTO MORDAZA ECO	
9	4406307.0	BPW	MUELLE POSICIONAMIENTO MORDAZA ECO	
10	4006310.0	BPW	BULON PLATO ANCLAJE CONVENCIONAL Ø 300 MM	Ø 32 / 38 X 153 MM
11	4006622.0	BPW	BULON PLATO ANCLAJE CONVENCIONAL Ø 360 MM	Ø 36 X 135 MM
12	4006230.0	BPW	CASQUILLO BRONCE PLATO ANCLAJE Ø 300 MM	Ø 32 / 36 X 54 MM
13	4006308.0	BPW	CASQUILLO BRONCE PLATO ANCLAJE Ø 360 MM	Ø 36 / 40 X 60 MM
14	2106302.1	BPW	FORRO FRENO BPW SN-3020	300 X 200 X 18 MM
15	2106362.1	BPW	FORRO FRENO BPW SN-3620 INFERIOR	360 X 200 X 18 MM 10 Remaches
15A	2106362.2	BPW	FORRO FRENO BPW SN-3620 SUPERIOR	360 X 200 X 18 MM 8 Remaches
16	3838016.2	BPW	REMACHE S/TUBULAR ACERO LATONADO	Ø 8 X 16 (Bolsa de 1000 Unds.)
17	4406202.0	BPW	PASADOR MUELLE	Ø 12 X 120 MM

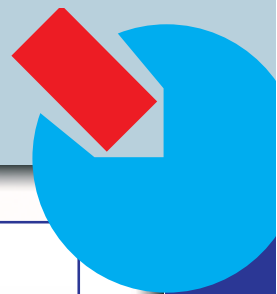

Figura	Ref ^o ADR98	Aplicación	Descripción	Medidas
1	3506200.3	BPW	MORDAZA DE FRENO SN-4220 C/RODILLO	420 X 200 RODILLO Ø 26 MM
2	3506180.3	BPW	MORDAZA DE FRENO SN-4218 C/RODILLO	420 X 180 RODILLO Ø 26 MM
3	3506200.5	BPW	MORDAZA FRENO SN-4220 BPW ECO	420 X 200
4	3506180.5	BPW	MORDAZA FRENO SN-4218 BPW ECO	420 X 180
5	4406607.0	BPW	MUELLE RECUPERACION ZAPATA CONV.	262 X 25 X 4
5A	4406262.0	BPW	MUELLE RECUPERACION ZAPATA CONV.	262 X 25 X 4
6	4406406.0	BPW	MUELLE TENSOR ZAPATA	105 X 21 X 4 MM
7	4406803.0	BPW	MUELLE RECUPERACION ZAPATA ECO95	268 X 33,8 X 5,3 MM
7A	4406268.0	BPW	MUELLE RECUPERACION ZAPATA ECO95	268 X 33,8 X 5,3 MM
8	4106312.6	BPW	KIT RODILLO ZAPATA	Ø 26 MM
9	4006202.0	BPW	CIR-CLIPS BULON PLATO ANCLAJE ECO T.MOD.	Ø 32 X 10 X 2 MM
10	4106310.1	BPW	KIT RODILLO ZAPATA ECO COMPLETO	Ø 58 X 31 MM
11	4406306.0	BPW	MUELLE POSICIONAMIENTO MORDAZA ECO	
12	4406307.0	BPW	MUELLE POSICIONAMIENTO MORDAZA ECO	
13	4006622.0	BPW	BULON PLATO ANCLAJE CONVENCIONAL	Ø 36 X 135 MM
14	4006308.0	BPW	CASQUILLO BRONCE PLATO ANCLAJE CONVENC.	Ø 36 / 40 X 60 MM
15	4406805.0	BPW	PASADOR MUELLE	Ø 12 X 90 MM
16	2106421.1	BPW	FORRO FRENO BPW SN-4218	420 X 180 X 18 MM
17	2106422.1	BPW	FORRO FRENO BPW SN-4220	420 X 200 X 18 MM
18	3838016.2	BPW	REMACHE S/TUBULAR ACERO LATONADO	Ø 8 X 16 (Bolsa de 1000 Unds.)

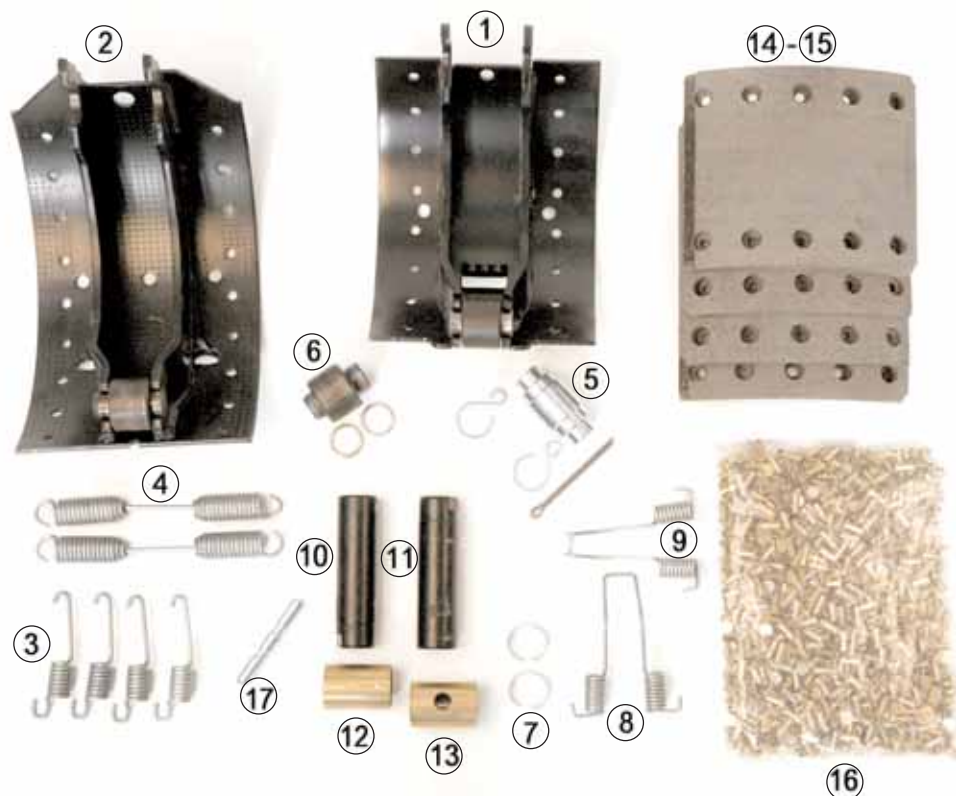

Figura	Refº ADR98	Aplicación	Descripción	Medidas
*	4206509.0	BPW	EJE LEVA BPW IZQUIERDO	Ø 42 MM L= 480 MM (Z)
*	4206510.0	BPW	EJE LEVA BPW DERECHO	Ø 42 MM L= 480 MM (S)
*	4206511.0	BPW	EJE LEVA BPW IZQUIERDO	Ø 42 MM L= 516 MM (Z)
*	4206512.0	BPW	EJE LEVA BPW DERECHO	Ø 42 MM L= 516 MM (S)
*	4206521.0	BPW	EJE LEVA BPW IZQUIERDO	Ø 42 MM L= 628 MM (Z)
*	4206522.0	BPW	EJE LEVA BPW DERECHO	Ø 42 MM L= 628 MM (S)
*	4206523.0	BPW	EJE LEVA BPW IZQUIERDO	Ø 42 MM L= 641 MM (Z)
*	4206524.0	BPW	EJE LEVA BPW DERECHO	Ø 42 MM L= 641 MM (S)
*	4206529.0	BPW	EJE LEVA BPW IZQUIERDO	Ø 42 MM L= 731 MM (Z)
*	4206530.0	BPW	EJE LEVA BPW DERECHO	Ø 42 MM L= 731 MM (S)
1	4206213.1	BPW	KIT REP. LEVA FRENO BPW 1 LEVA	6-18 TNS. H/R-KH-KR- > 1993
1A	4206309.2	BPW	KIT REP. LEVA FRENO BPW 2 LEVAS (1 EJE)	H-KH-N SN420/360
2	4606513.0	BPW	PALANCA FRENO MANUAL 7H. ECO	L= 220 MM 10 ESTRIAS
2A	4614010.0	BPW	PALANCA FRENO MANUAL ADR98 S/CUELLO	L= 220 MM 10 ESTRIAS
2B	4614010.1	BPW	PALANCA FRENO MANUAL ADR98 C/CUELLO	L= 220 MM 10 ESTRIAS
2C	4614010.2	BPW	PALANCA FRENO MANUAL ADR98 S/CUELLO	L= 305 MM 10 ESTRIAS
3	4606310.7	BPW	KIT PALANCAS AUTOMATICAS ECO-MASTER 7H	
3A	4606310.9	BPW	KIT PALANCAS AUTOMATICAS ADR98 ECO	

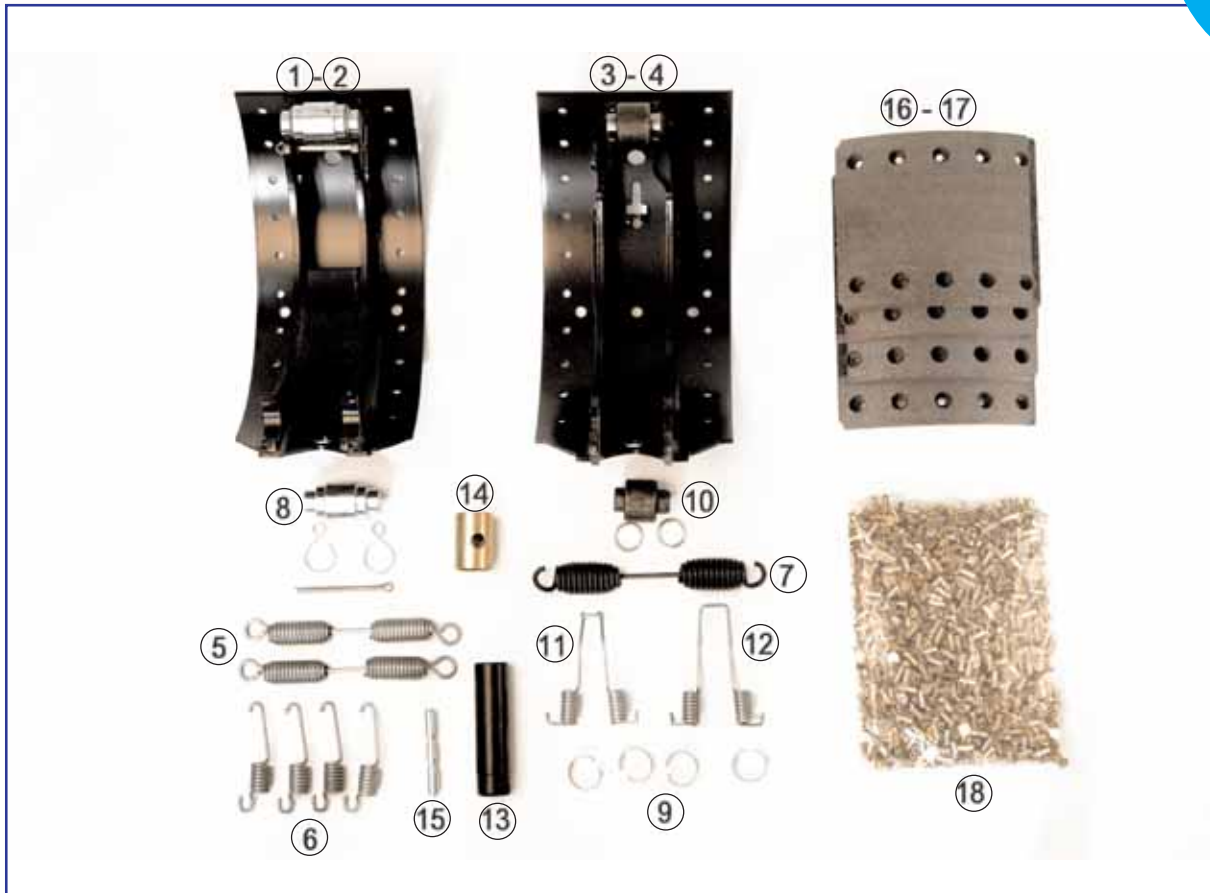
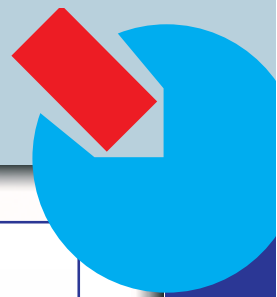

Figura	Refº ADR98	Aplicación	Descripción	Medidas
1	1706652.9	BPW	CALIPER FRENO BPW SB3745	
1A	1706653.9	BPW	CALIPER FRENO BPW SB3745	
2	1806340.1	BPW	DISCO FRENO 8T. ECO MAX / ECO PLUS 9Ton.	Ø 370 X 45 MM
2A	1806340.3	BPW	DISCO FRENO 8T. ECO MAX / ECO PLUS 10Ton. ABS	Ø 370 X 45 MM
2B	1806340.4	BPW	DISCO FRENO 10T. ECO MAX/ ECO PLUS 10Ton. ABS	Ø 370 X 45 MM
2C	1806340.6	BPW	DISCO FRENO 10T. ECO MAX / ECO PLUS 9Ton.	Ø 370 X 45 MM
2D	1806340.8	BPW	DISCO FRENO 10T. ECO PLUS CON BOMBEO	Ø 370 X 45 MM
3	1006370.1	BPW	CJTO. PASTILLAS SB-3745	210 X 93 X 30 MM
4	9543201.0	BPW	CAMARA FRENO DISCO DE 16" IZQUIERDA	T-16"
4A	9543401.0	BPW	CAMARA FRENO DISCO DE 20" IZQUIERDA	T-20"
4B	9543501.0	BPW	CAMARA FRENO DISCO DE 22" IZQUIERDA	T-22"
4C	9543202.0	BPW	CAMARA FRENO DISCO DE 16" DERECHA	T-16"
4D	9543402.0	BPW	CAMARA FRENO DISCO DE 20" DERECHA	T-20"
4E	9543502.0	BPW	CAMARA FRENO DISCO DE 22" DERECHA	T-22"
5	9544103.0	BPW	ACTUADOR FRENO DISCO IZQUIERDO	T- 16 / 16 "
5A	9544104.0	BPW	ACTUADOR FRENO DISCO DERECHO	T- 16 / 16 "
5B	9544001.0	BPW	ACTUADOR FRENO DISCO IZQUIERDO	T- 16 / 24"
5C	9544002.0	BPW	ACTUADOR FRENO DISCO DERECHO	T- 16 / 24"
5D	9544301.0	BPW	ACTUADOR FRENO DISCO IZQUIERDO	T- 20 / 24"
5E	9544302.0	BPW	ACTUADOR FRENO DISCO DERECHO	T- 20 / 24"
6	1706632.0	BPW	KIT EMPUJADORES CALIPER	Todos los modelos
7	1706633.0	BPW	KIT GUIAS Y CASQUILLOS CALIPER	Todos los modelos



Figura	Ref ^o ADR98	Aplicación	Descripción	Medidas
1	1706708.4	BPW	CALIPER FRENO BPW SB-4345	
1A	1706709.4	BPW	CALIPER FRENO BPW SB-4345	
2	1806350.1	BPW	DISCO FRENO 10T. ECO MAX 10 Ton. ABS	Ø 430 X 45 MM
2A	1806350.5	BPW	DISCO FRENO 10T. ECO MAX / ECO PLUS 9 - 12 Ton.	Ø 430 X 45 MM
3	1006430.2	BPW	CJTO. PASTILLAS SB-4345	248 X 109 X 30 MM
4	9543201.0	BPW	CAMARA FRENO DISCO DE 16" IZQUIERDA	T-16"
4A	9543401.0	BPW	CAMARA FRENO DISCO DE 20" IZQUIERDA	T-20"
4B	9543501.0	BPW	CAMARA FRENO DISCO DE 22" IZQUIERDA	T-22"
4C	9543202.0	BPW	CAMARA FRENO DISCO DE 16" DERECHA	T-16"
4D	9543402.0	BPW	CAMARA FRENO DISCO DE 20" DERECHA	T-20"
4E	9543502.0	BPW	CAMARA FRENO DISCO DE 22" DERECHA	T-22"
5	9544103.0	BPW	ACTUADOR FRENO DISCO IZQUIERDO	T- 16 / 16 "
5A	9544104.0	BPW	ACTUADOR FRENO DISCO DERECHO	T- 16 / 16 "
5B	9544001.0	BPW	ACTUADOR FRENO DISCO IZQUIERDO	T- 16 / 24"
5C	9544002.0	BPW	ACTUADOR FRENO DISCO DERECHO	T- 16 / 24"
5D	9544301.0	BPW	ACTUADOR FRENO DISCO IZQUIERDO	T- 20 / 24"
5E	9544302.0	BPW	ACTUADOR FRENO DISCO DERECHO	T- 20 / 24"
6	1706632.0	BPW	KIT EMPUJADORES CALIPER	Todos los modelos
7	1706633.0	BPW	KIT GUIAS Y CASQUILLOS CALIPER	Todos los modelos



Figura	Refº ADR98	Aplicación	Descripción	Medidas
1	1706706.0	BPW	CALIPER FRENO TANGENCIAL BPW SB-3745	
1A	1706706.1	BPW	CALIPER FRENO TANGENCIAL BPW SB-3745	
1B	1706706.2	BPW	CALIPER FRENO TANGENCIAL BPW SB-4309	
1C	1706706.3	BPW	CALIPER FRENO TANGENCIAL BPW SB-4309	
1D	1706706.4	BPW	CALIPER FRENO TANGENCIAL BPW SB-4345	
1E	1706706.5	BPW	CALIPER FRENO TANGENCIAL BPW SB-4345	
2	1806341.0	BPW	DISCO FRENO 10T. ECO PLUS 9Ton. Con / sin Bombeo	Ø 370 X 45 MM
2A	1806341.3	BPW	DISCO FRENO 10T. ECO PLUS 10T. ABS	Ø 370 X 45 MM
2B	1806350.5	BPW	DISCO FRENO 10T. ECO MAX / ECO PLUS 9 - 12 Ton.	Ø 430 X 45 MM
3	1006643.0	BPW	CJTO. PASTILLAS FRENO SB3745 TANGENCIAL	210 X 92 X 30
4	1006644.0	BPW	CJTO. PASTILLAS FRENO SB4309 TANGENCIAL	247 X 105 X 30
5	1006645.0	BPW	CJTO. PASTILLAS FRENO SB4345 TANGENCIAL	248 X 109 X 30
6	9543201.0	BPW	CAMARA FRENO DISCO DE 16" IZQUIERDA	T-16"
6A	9543401.0	BPW	CAMARA FRENO DISCO DE 20" IZQUIERDA	T-20"
6B	9543501.0	BPW	CAMARA FRENO DISCO DE 22" IZQUIERDA	T-22"
6C	9543202.0	BPW	CAMARA FRENO DISCO DE 16" DERECHA	T-16"
6D	9543402.0	BPW	CAMARA FRENO DISCO DE 20" DERECHA	T-20"
6E	9543502.0	BPW	CAMARA FRENO DISCO DE 22" DERECHA	T-22"
7	9544103.0	BPW	ACTUADOR FRENO DISCO IZQUIERDO	T- 16 / 16 "
7A	9544104.0	BPW	ACTUADOR FRENO DISCO DERECHO	T- 16 / 16 "
7B	9544001.0	BPW	ACTUADOR FRENO DISCO IZQUIERDO	T- 16 / 24"
7C	9544002.0	BPW	ACTUADOR FRENO DISCO DERECHO	T- 16 / 24"
7D	9544301.0	BPW	ACTUADOR FRENO DISCO IZQUIERDO	T- 20 / 24"
7E	9544302.0	BPW	ACTUADOR FRENO DISCO DERECHO	T- 20 / 24"
8	1706632.0	BPW	KIT EMPUJADORES CALIPER	Todos los modelos
9	1706633.0	BPW	KIT GUIAS Y CASQUILLOS CALIPER	Todos los modelos



Figura	Ref ^o ADR98	Aplicación	Descripción	Medidas
1	9542001.0	VARIOS	ACTUADOR FRENO TAMBOR	T - 24" / 30"
1A	9542101.0	VARIOS	ACTUADOR FRENO TAMBOR	T - 30" / 30"
2	9544103.0	BPW	ACTUADOR FRENO DISCO IZQUIERDO	T - 16 / 16 "
2A	9544104.0	BPW	ACTUADOR FRENO DISCO DERECHO	T - 16 / 16 "
2B	9544001.0	BPW	ACTUADOR FRENO DISCO IZQUIERDO	T - 16 / 24"
2C	9544002.0	BPW	ACTUADOR FRENO DISCO DERECHO	T - 16 / 24"
2D	9544301.0	BPW	ACTUADOR FRENO DISCO IZQUIERDO	T - 20 / 24"
2E	9544302.0	BPW	ACTUADOR FRENO DISCO DERECHO	T - 20 / 24"
3	9541402.0	BPW	CAMARA FRENO TAMBOR	T - 20"
3A	9541501.0	BPW	CAMARA FRENO TAMBOR	T - 24"
3B	9541601.0	BPW	CAMARA FRENO TAMBOR	T - 30"
4	9543201.0	BPW	CAMARA FRENO DISCO DE 16" IZQUIERDA	T-16"
4A	9543401.0	BPW	CAMARA FRENO DISCO DE 20" IZQUIERDA	T-20"
4B	9543501.0	BPW	CAMARA FRENO DISCO DE 22" IZQUIERDA	T-22"
4C	9543202.0	BPW	CAMARA FRENO DISCO DE 16" DERECHA	T-16"
4D	9543402.0	BPW	CAMARA FRENO DISCO DE 20" DERECHA	T-20"
4E	9543502.0	BPW	CAMARA FRENO DISCO DE 22" DERECHA	T-22"
5	9541037.0	BPW	CAMARA ELEVADOR BILATERAL CON RODILLO	

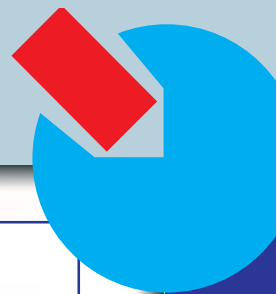

Figura	Refº ADR98	Aplicación	Descripción	Medidas
1	5006001.0	BPW	DIAPRES DE SUSPENSION SEMI-COMPLETO	360 X 530 MM (D-36)
1	5006003.0	BPW	DIAPRES DE SUSPENSION SEMI-COMPLETO	300 X 520 MM (D-30)
1	5006005.0	BPW	DIAPRES DE SUSPENSION SEMI-COMPLETO	360 X 610 MM (D-36-1)
1	5006091.0	BPW	DIAPRES DE SUSPENSION SEMI-COMPLETO	300 X 423 MM (D-30 K)
1	5006101.0	BPW	DIAPRES DE SUSPENSION SEMI-COMPLETO	360 X 430 MM (D-36 K)
2	5006169.0	BPW	DIAPRES DE SUSPENSION COMPLETO	360 X 610 MM (D-36-1)
2	5006320.0	BPW	DIAPRES DE SUSPENSION COMPLETO	300 X 520 MM (D-30)
2	5006321.0	BPW	DIAPRES DE SUSPENSION COMPLETO	300 X 423 MM (D-30 K)
2	5006341.0	BPW	DIAPRES DE SUSPENSION COMPLETO	360 X 430 MM (D-36 K)
2	5006351.0	BPW	DIAPRES DE SUSPENSION COMPLETO	360 X 530 MM (D-36)
3	5206520.0	BPW	AMORTIGUADOR SUSPENSION STANDARD B	L = 496 - K = 426 MM
4	5206252.0	BPW	AMORTIGUADOR SUSPENSION STANDARD K	L = 495 - K = 425 MM
5	5506030.2	BPW	SILENTBLOK SUSP. GOMA-ACERO	Ø 30 X Ø 60 X 102 MM
6	5506030.3	BPW	SILENTBLOK SUSP. ACERO-GOMA-ACERO	Ø 30 X Ø 57 X 102 MM
7	5706504.0	BPW	BULON SUSP.NEUMATICA SIN TUERCA	M30 X 200 (CABEZA REDONDA)
8	5706832.1	BPW	BULON SUSP.NEUMATICA C/TUERCA	M30 X 210 MM
9	5706537.0	BPW	BULON SUSP.NEUMATICA CON ELEVADOR	M30 X 265 MM
10	5706533.0	BPW	BULON SUSP.NEUMATICA CON ELEVADOR	M30 X 290 MM

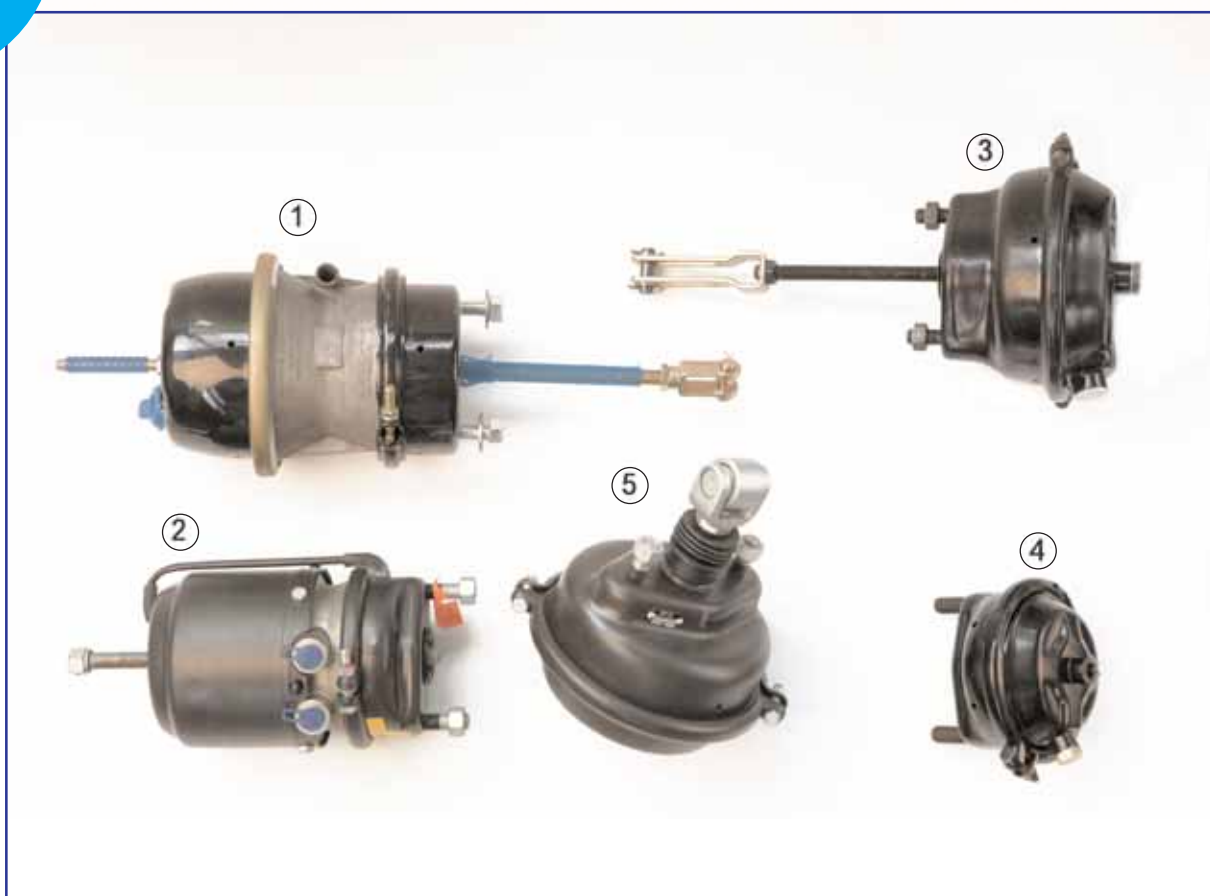

Figura	Refº ADR98	Aplicación	Descripción	Medidas
1	5606005.1	BPW	BALANCIN SUSPENSION TIPO VB 10-12 TN.	125 X 220 X 455 MM
2	5626005.2	BPW	BALANCIN SUSPENSION TIPO VG 6,5-9 TNS.	110 X 165 X 400 MM
3	5506050.1	BPW	SILENTBLOK BALANCIN	Ø 50 X Ø 100 X 130 MM
4	5506060.1	BPW	SILENTBLOK BALANCIN	Ø 60 X Ø 110 X 130 MM
5	5606008.1	BPW	BULON BALANCIN C/TUERCA	Ø 50 X 235 MM
6	5606008.2	BPW	BULON BALANCIN C/TUERCA	Ø 60 X 230 MM
7	5606063.1	BPW	TUERCA BULON BALANCIN	M42
8	5626310.2	BPW	KIT REP. BALANCIN CONICO SUSP. VG	

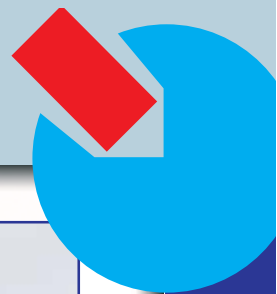
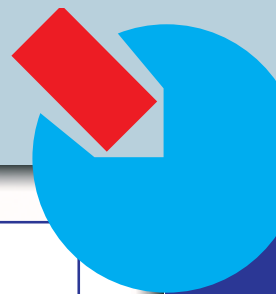

Figura	Refº ADR98	Aplicación	Descripción	Medidas
1	5706059.3	BPW	TIRANTE EXTENSIBLE COMPLETO CON SILENTBLOK	510 - 570 MM
2	5706059.2	BPW	TIRANTE EXTENSIBLE COMPLETO CON SILENTBLOK	450 - 500 MM
3	5706059.1	BPW	TIRANTE EXTENSIBLE COMPLETO CON SILENTBLOK	320 - 380 MM
4	5706009.1	BPW	CABEZA TIRANTE EXTENSIBLE ROSCA IZQUIERDA	M36*2
5	5706009.2	BPW	CABEZA TIRANTE EXTENSIBLE ROSCA DERECHA	M36*2
6	5506024.0	BPW	SILENTBLOK TIRANTE	Ø 24 X Ø 58 X 68 MM
7	5506030.1	BPW	SILENTBLOK TIRANTE	Ø 30 X Ø 60 X 68 MM
8	5506030.0	BPW	SILENTBLOK TIRANTE	Ø 30 X Ø 60 X 68 MM
9	5706821.9	BPW	BULON TIRANTE C/TUERCA	M24 X 190 MM
10	5706831.4	BPW	BULON TIRANTE C/TUERCA	M30 X 140 MM
11	5706831.5	BPW	BULON TIRANTE C/TUERCA	M30 X 150 MM
12	5706831.6	BPW	BULON TIRANTE C/TUERCA	M30 X 160 MM
13	5706831.7	BPW	BULON TIRANTE C/TUERCA	M30 X 170 MM
14	5706831.9	BPW	BULON TIRANTE C/TUERCA	M30 X 190 MM



Figura	Refª ADR98	Aplicación	Descripción	Medidas
1	2206031.0	BPW	GRASA LARGA DURACION ECO-LI	5 KGS
1A	2206032.0	BPW	GRASA LARGA DURACION ECO-LI	10 KGS
1B	2206033.0	BPW	GRASA LARGA DURACION ECO-LI	50 KGS
2	2206047.0	BPW	GRASA LARGA DURACION ECO-LI PLUS	5 KGS.
2A	2206048.0	BPW	GRASA LARGA DURACION ECO-LI PLUS	10 KGS.
2B	2206049.0	BPW	GRASA LARGA DURACION ECO-LI PLUS	25 KGS.
3	2606040.1	BPW	LLAVE TAPACUBOS ANTIGUO 6,5 - 9 TNS.	SW 95
3A	2606050.1	BPW	LLAVE TAPACUBOS ANTIGUO 10 - 12 TNS.	SW 110
4	2606040.3	BPW	LLAVE TAPACUBOS MODERNO 6,5 - 9 TNS.	SW 95
4A	2606050.4	BPW	LLAVE TAPACUBOS MODERNO 10 - 12 TNS.	SW 110
5	2606060.3	BPW	LLAVE TUBO PARA TAPACUBOS Y TUERCA BUJE	SW 95 / 95 6,5 - 9 TNS.
5A	2606070.3	BPW	LLAVE TUBO PARA TAPACUBOS Y TUERCA BUJE	SW 80 / 110 10 - 12 TNS.
6	3006605.0	BPW	LLAVE TUERCA BUJE ECO-PLUS	SW 95
7	2706327.0	BPW	HUBODOMETRO INTEGRADO EN TAPACUBOS	HS 9T. 385 / 65 R 22,5
7A	2706429.0	BPW	HUBODOMETRO INTEGRADO EN TAPACUBOS	HS 9T. 385 / 65 R 22,5 ECO
7B	2706544.0	BPW	HUBODOMETRO INTEGRADO EN TAPACUBOS	HS 9T. 385 / 55 R 22,5 ECO PLUS
7C	2706546.0	BPW	HUBODOMETRO INTEGRADO EN TAPACUBOS	HS 9T. 385 / 65 R 22,5 ECO PLUS